

### FEATURES

- DC output adjustable (+/-10%)
- Cooling by free air convection
- Can be installed on DIN rail TS-35/7.5 or 15
- Protections: Short circuit, overload, over voltage, input reverse polarity, input under voltage protection
- 4Kdc I/O isolation (reinforced isolation)
- 3 years warranty



**DC0512**  
12VDC → 12VDC  
24VDC → 12VDC



**DC0324**  
12VDC → 24VDC  
24VDC → 24VDC



**DC0524-12**  
12VDC → 24VDC



**DC0524-24**  
24VDC → 24VDC

		DC0512	DC0324	DC0524-12	DC0524-24	
<b>OUTPUT</b>	DC VOLTAGE	12V	24V	24V	24V	
	RATED CURRENT	5A	2.5A	4.2A	5A	
	CURRENT RANGE	0 ~ 5A	0 ~ 3A (2.5A)	0 ~ 4.2A	0 ~ 5A	
	RATED POWER	60 W		100.8 W	120 W	
	PEAK CURRENT	N/A	N/A	6.3A	7.5A	
	PEAK POWER	N/A	N/A	150W (3sec.)	180W (3 sec.)	
	RIPPLE & NOISE (Max.)	75mVp-p	100mVp-p	50mVp-p		
	VOLTAGE ADJ. RANGE (By default)	9 ~ 13.2V	21.6V ~ 28V	24 ~ 28V		
	VOLTAGE TOLERANCE	+/- 2.0%		+/- 1.0%		
	LINE REGULATION	+/- 0.5%		+/- 0.5%		
	LOAD REGULATION	+/- 0.5%		+/- 1.0%		
	SETUP, RISE TIME	120ms, 85ms at full load		500ms, 60ms at 12V <sub>DC</sub>	500ms, 60ms at 24V <sub>DC</sub>	
<b>INPUT</b>	VOLTAGE RANGE	9 ~ 36V <sub>DC</sub>		9 ~ 18V <sub>DC</sub>	16.8 ~ 33.6V <sub>DC</sub>	
	EFFICIENCY (Typ.)	91%		88.5%	89.5%	
	DC CURRENT (Typ.)	3A/24V <sub>DC</sub>		11.2A@12V <sub>DC</sub>	5.6A@24V <sub>DC</sub>	
	INRUSH CURRENT (Typ.)	20A/24V <sub>DC</sub>		5A/12V <sub>DC</sub>	5A/24V <sub>DC</sub>	
<b>PROTECTION</b>	OVERLOAD	105 ~ 130% rated output power Protection type: constant current limiting, recovers automatically after fault condition is removed.		Normally works within 150% rated output power for more than 3 seconds and then constant current protection 105 ~ 135% rated output power with auto-recovery.		
	OVER VOLTAGE	13.8 - 16.2V	28.8 - 34V	28.8 ~ 33.6V		
	REVERSE POLARITY	Protection type: shut down o/p voltage, re-power on to recover				
	UNDER VOLTAGE LOCKOUT	24Vin: Power ON ≥ 9V, OFF ≤ 8.5V		12Vin: Power ON ≥ 9V, OFF ≤ 8.5V	24Vin: Power ON ≥ 16.8V, OFF ≤ 16.5V	
	WORKING TEMPERATURE	(-)40 ~ (+)85°C			(-)40 ~ (+)70°C	
<b>ENVIRONMENT</b>	WORKING HUMIDITY	5 ~ 95% RH non condensing				
	STORAGE TEMP, HUMIDITY	(-)40 ~ (+)85°C, 5 ~ 95% RH non-condensing				
	TEMP. COEFFICIENT	(+)0.03%/°C (0 ~ 60°C)		(+)0.03%/°C (0 ~ 55°C)		
	VIBRATION	Component: 10 ~ 500Hz, 2G 10min./1cycle, period for 60min each along X, Y, Z axes ; Mounting (for DC0512 & DC0324): Compliance with IEC60068-2-6.		Mounting (for DC0524-12 & DC0524-24): Compliance with IEC61373		
<b>OTHERS</b>	OPERATING ALTITUDE	2000 meters		5000 meters		
	MTBF	611Khrs min MIL-HDBK-217F (25°C)		214.6Khrs min MIL-HDBK-217F (25°C)		
	DIMENSION (W x H x D)	52.5 x 90 x 54.5mm		32 x 125.2 x 102mm		
	PACKING	216g		510g		

### COMPLEMENTARY INFORMATION

	DC0512	DC0324	DC0524-12	DC0524-24
SAFETY & EMC	SAFETY STANDARDS IEC 62368-1 (LVD), AS/NZS 62368.1 approved.			
	WITHSTAND VOLTAGE I/P-O/P:4KV <sub>DC</sub>		I/P-O/P:4KV <sub>DC</sub>	
	ISOLATION RESISTANCE I/P-O/P>100M Ohm / 500V <sub>DC</sub> / 25°C / 70% RH		I/P-O/P, I/P-FG, O/P-FG:>100M Ohm / 500V <sub>DC</sub> / 25°C / 70% RH	
	EMC EMISSION EN55032 Class A, EN55032 Class A for 1m I/O cable, Class B for 30cm I/O cable, EN61000-3-3.		For DC052412 & DC0524-24: EN55032 Class B, EN61000-3-3	
	EMC IMMUNITY EN55024, EN61000-6-2 (EN50085-2), EN61000-4-2 Level 3, 8KV air. Level 3, 6KV contact; criteria A, EN61000-4-3 Level 3, 10V/m; criteria A, EN61000-4-4 Level 3, 2KV; criteria A, EN61000-4-5 Level 3, 1KV/Line-line; criteria A, EN61000-4-6 Level 3, 10V; criteria A, EN61000-4-8 Level 4, 30A/m; criteria A		EN55024, EN61000-6-2 (EN50085-2), EN61000-4-2 Level 3, 8KV air. Level 3, 6KV contact; criteria A, EN61000-4-3 Level 3, 10V/m; criteria A, EN61000-4-4 Level 3, 2KV; criteria A, EN61000-4-5 Level 3, 1KV/Line-line; Level 3, 2KV/Line-Line-FG; criteria A, EN61000-4-6 Level 3, 10V; criteria A, EN61000-4-8 Level 4, 30A/m; criteria A	

### MECHANICAL SPECIFICATIONS

DC0512/DC0324

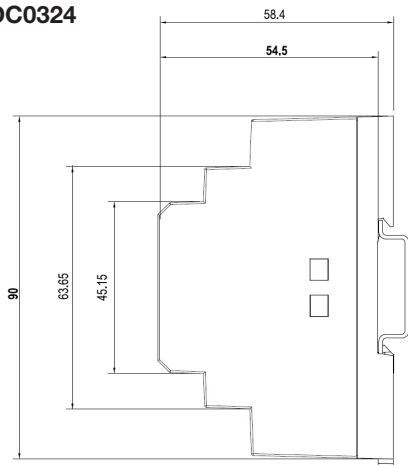

DC0524-12/DC0524-24

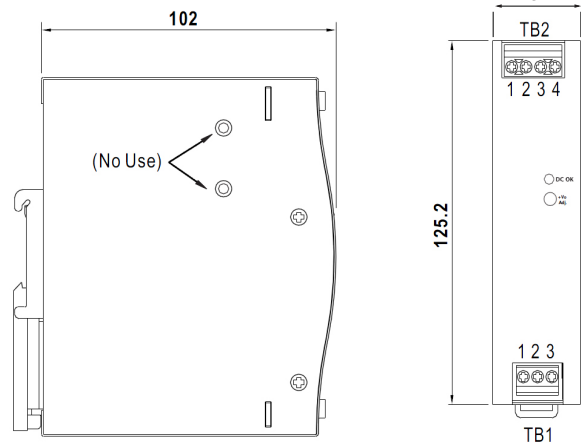

### DERATING CURVES/TEMPERATURE

DC0512/DC0324

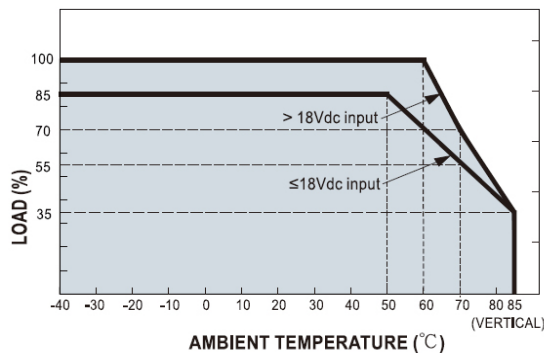

DC0524-12/DC0524-24

